

Gripple Plus Range (Trellising)



The Gripple Plus range of wire joiners and tensioners is suitable for all trellis applications.

FEATURES / BENEFITS

- Join and tension in one
- Eliminates tying and knotting wires, reducing installation time
- Ideal for use on high tensile and mild steel trellis wire
- Designed for high load holding and corrosion resistance
- Easily re-tensioned year-after-year



SPECIFICATION

Product	Wire Range	Standard Wire Gauge	Maximum Working Load
Gripple Plus Small	1.40 mm - 2.20 mm	17 SWG - 14 SWG	300 kg
Gripple Plus Medium	2.00 mm - 3.25 mm	14 SWG - 10 SWG	400 kg
Gripple Plus Large	3.20 mm - 4.20 mm	10 SWG - 7½ SWG	600 kg
Jumbo*	2.50 mm - 3.15 mm	12½ SWG - 10 SWG	600 kg

INSTALLATION

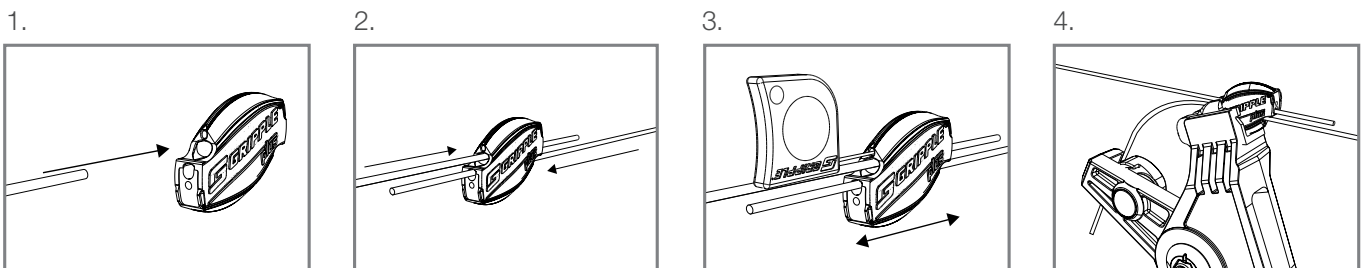

*Jumbo is not compatible with the Setting Key.

TIPS

- Apply and re-apply tension with a tensioning tool (leave at least 75 mm tail wire)
- Reposition before applying tension using a Setting Key
- For video installation instructions visit our YouTube channel GrippleTV UK



PI-GRIPPLEPLUS-T-ENG

www.gripple.com

Gripple's policy is one of continuous development and innovation. We therefore reserve the right to alter specifications, etc. without notice.

Gripple Ltd | The Old West Gun Works | Savile Street East | Sheffield S4 7UQ
Tel 0800 018 4264 Fax 0114 275 1155 email info@gripple.com